

JOB \_\_\_\_\_ ITEM # \_\_\_\_\_ QTY # \_\_\_\_\_

**MODEL NUMBER:**

- ☐ BPS
- ☐ CTS

**DIMENSIONS:**

- BPS - 36"H x 28"D X 39"L
- CTS - 36"H x 28"D X 32"L

**CTS**

- Cutouts in the top for six silverware cups and an optional drop-in style napkin dispenser
- 20-gauge stainless steel inner shelf to accommodate a single stack of trays up to 15" x 20" with a capacity of up to 75 trays to the top of the unit

**BTS**

- Cutouts in the top for five silverware cups
- 20-gauge stainless steel end panels and two inner shelves to accommodate three stacks of 9" plates on each side with shelves sloped toward the center wall

**COMMON OPTIONS**

- Napkin dispenser
- Legs in lieu of casters
- Stainless steel cylinders
- See reverse side for additional options.

**WARRANTY**

One year parts and labor. Warranty is detailed on inside front cover of the price list.



CTS

The Elite 500 Tray or Plate Stand is a must to begin your line-up. It's versatile design provides a place for all the required utensils. Elite 500 units are compatible and will interlock with other Elite 500 units. This allows the units to be disconnected for cleaning under the serving line.

**STANDARD FEATURES**

- 14-gauge stainless steel top with 1-1/2" turndown on all sides
- Top secured by four recessed bolts
- 14-gauge stainless steel legs
- 18-gauge stainless steel bottom shelf
- 20-gauge stainless steel panels are attached to legs
- 5" diameter swivel plate casters, 2 with brakes
- Interlocking mechanism is provided to interlock with other Elite 500 units
- 6 plastic cylinders

SPEC A-12

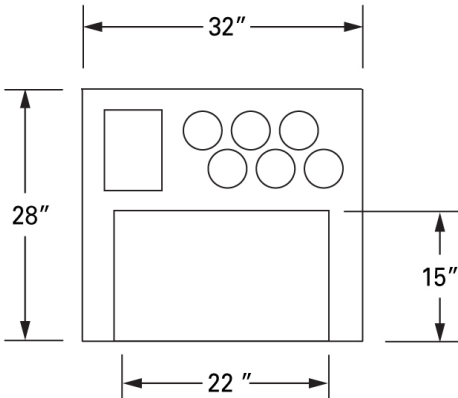

Model CTS

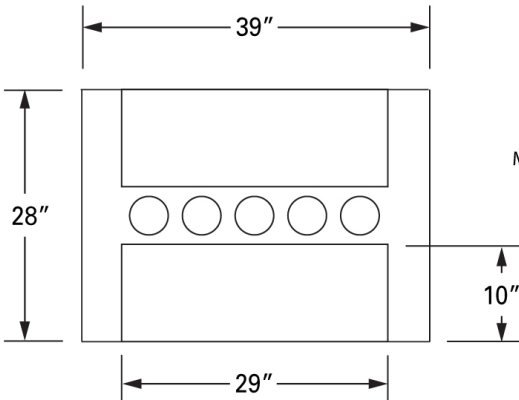
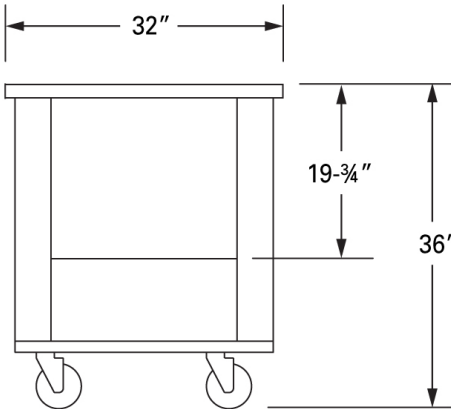

Model BTS

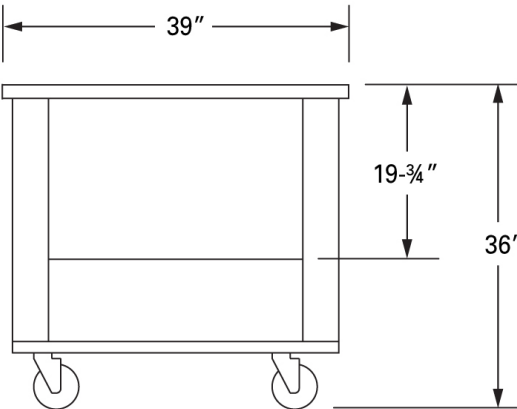

Options

Part #	Description	Part #	Description
<input type="checkbox"/> 0098240	Napkin Dispenser for CTS ONLY - hold napkins 6-1/2" x 3-1/2"	<input type="checkbox"/> PPC	Pizzazz Powder Coating
<input type="checkbox"/> 0098241	Napkin Dispenser - hold napkins 6-1/2" x 4-1/4" to 6-1/2" x 5-1/4"	<input type="checkbox"/> SKR	Skirting
<input type="checkbox"/> FRMA	Formica laminate finish	<input type="checkbox"/> SSL	Legs in lieu of casters