

JOB _____ ITEM # _____ QTY # _____

MODEL NUMBER:

- ☐ R2-BCM ☐ R4-BCM ☐ R6-BCM
☐ R3-BCM ☐ R5-BCM

DIMENSIONS:

- R2-BCM - 36"H x 30"D X 36"L
- R3-BCM - 36"H x 30"D X 50"L
- R4-BCM - 36"H x 30"D X 60" L
- R5-BCM - 36"H x 30"D X 74"L
- R6-BCM - 36"H x 30"D X 96"L

*Amperage/NEMA plug type may vary with options.
 Petite Reflections is 30" high - under counter storage is shortened and does not have intermediate shelf.

NSF/ANSI STANDARD 7

This unit is listed with CSA in NSF/ANSI Standard 7 for design and construction and has been performance tested for the storage of potentially hazardous foods. The performance test criteria is holding a food-like media at or below 41°F without any freezing for four hours at 86°F ambient temperature.

STANDARD COLORS

- Wine Red (RAL 3005)
- Signal Red (RAL 3001)
- Yellow (RAL 1021)
- Light Blue (RAL 5012)
- Gentiane Blue (RAL 5010)
- Water Blue (RAL 5021)
- Moss Green (RAL 6005)
- Squirrel Gray (RAL 7000)
- Black
- White
- Custom colors available
- Optional Graphics Packages available

COMMON OPTIONS

- Tray slides
- Protector guards
- Refrigerated storage base
- See reverse side for additional options

WARRANTY

- One year parts and labor. Warranty is detailed on inside front cover of the price list.



R5-BCM shown with optional dual RSRTS and RBPGC

The Piper Bloomington Cold Food Unit features an extra deep cold pan of 9-7/16" deep and is listed NSF/ANSI Standard 7. The Bloomington Cold Units are designed to serve a variety of refrigerated food products, these units are ideal as a salad bar merchandiser. Reflections units are compatible and will interlock with other Reflections units.

STANDARD FEATURES

- Seamless, molded FRP body with smooth exterior and rounded corners
- 14-gauge stainless steel top with fully welded square turndowns on all sides
- Enclosed base
- 20-gauge stainless steel fully welded 9-7/16" deep cold pan
- Fully hermetic condensing unit, located on slide-out rails behind removable louvered panels for cross-flow ventilation
- Welded watertight well has a concealed continuous refrigerated coil bonded to the sides and is fully insulated
- Cold pan has a 3/4" FPT drain ball valve located below the unit
- 4" diameter swivel plate casters with brakes
- Interlocking mechanism is provided to interlock with other Reflections units

ELECTRICAL

- Units available in 120 volt standard
- Seven foot electrical cord and plug

REFRIGERATION SYSTEM

- 1/3 horsepower compressor
- Fan-cooled condensing unit with an expansion valve pressure control switch
- Refrigerant coils shall be of copper tubing wrapped around the sides of the well

SPEC B-14

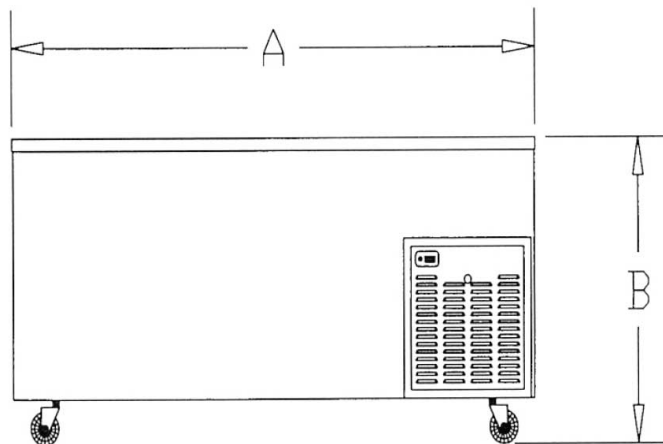
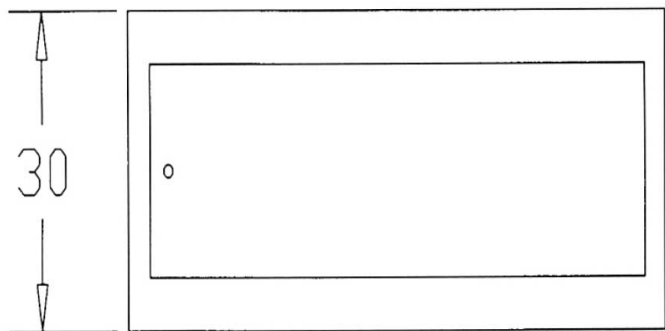

Model #	Description	(A) Length	Width	(B) Height	Amps 120V	NEMA Cap Number	Ship Wt. (lbs)
R2-BCM	2-12x20 Pan Capacity	36"	30"	36"	6.3	5-15P	350
R3-BCM	3-12x20 Pan Capacity	50"	30"	36"	6.3	5-15P	485
R4-BCM	4-12x20 Pan Capacity	60"	30"	36"	6.3	5-15P	500
R5-BCM	5-12x20 Pan Capacity	74"	30"	36"	6.3	5-15P	580
R6-BCM	6-12x20 Pan Capacity	96"	30"	36"	6.3	5-15P	640

DIMENSION ADDITIONS FOR OPTIONS

- Add 23-3/4" to height for buffet protector guard
- Add 14" to height for cafeteria protector guard
- Add 22-3/4" to height for double display shelf
- Add 8" to width for cutting board
- Add 12-3/4" to width for solid ribbed tray slide
- Add 12-1/2" to width for 3-bar tray slide

Note: Line-up drawing required when ordering false front, cashier stand or interconnected units.

Part #	Description
<input type="checkbox"/> R3BTS	3-bar tray slide
<input type="checkbox"/> RBDD	Two tier buffet protector guard
<input type="checkbox"/> RBDDL	Two tier buffet protector guard with fluorescent lights
<input type="checkbox"/> RBEG	Buffet end guards (pr)
<input type="checkbox"/> RBHL	Heat lamps, bullet-type (buffet only)
<input type="checkbox"/> RBKR	Common circuit breaker for well heaters only
<input type="checkbox"/> RBL	Stainless steel 6" adjustable bullet feet
<input type="checkbox"/> RBPG	Buffet style protector guard
<input type="checkbox"/> RBPG1	Single sided buffet style protector guard
<input type="checkbox"/> RBPG1C	Classic single sided tubular glass buffet guard
<input type="checkbox"/> RBPG1FL	Single sided buffet style protector guard with fluorescent lights
<input type="checkbox"/> RBPG1IL	Single sided buffet style protector guard with incandescent lights
<input type="checkbox"/> RBPGC	Classic tubular glass buffet guard
<input type="checkbox"/> RBPGFL	Buffet style protector guard with fluorescent lights
<input type="checkbox"/> RBPGH	Buffet style protector guard with heat strips
<input type="checkbox"/> RBPGIL	Buffet style protector guard with incandescent lights
<input type="checkbox"/> RCDD	Two tier cafeteria protector guard
<input type="checkbox"/> RCDDC	Classic two tier tubular glass cafeteria guard
<input type="checkbox"/> RCDDL	Two tier cafeteria protector guard with fluorescent lights
<input type="checkbox"/> RCEG	Cafeteria end guards (pr)

Part #	Description
<input type="checkbox"/> RCPG	Cafeteria style protector guard
<input type="checkbox"/> RCPGC	Classic tubular glass cafeteria guard
<input type="checkbox"/> RCPGFL	Cafeteria style protector guard with fluorescent lights
<input type="checkbox"/> RCPGH	Cafeteria style protector guard with heat strips
<input type="checkbox"/> RCPGHL	Cafeteria style protector guard with heat and light strips
<input type="checkbox"/> RCPGL	Cafeteria style protector guard with incandescent lights
<input type="checkbox"/> RDOUT	Duplex Outlet (120V, 15 AMP)
<input type="checkbox"/> RDRN	Drain and manifold with shut-off valve
<input type="checkbox"/> RHD	Under storage hinged doors
<input type="checkbox"/> RHU	Heated storage base with doors and pan slides (convertible racks hold 10-2" deep 12" x 20" pans or 10 - 18" x 26" bun pans)
<input type="checkbox"/> RMCB	8" maple cutting board
<input type="checkbox"/> RMRCE	Extended compressor warranty
<input type="checkbox"/> ROHS	Overhead shelf
<input type="checkbox"/> ROU	Open under storage with shelf
<input type="checkbox"/> RRU	Refrigerated storage base with doors and pan slides: holds 8-2" deep 12" x 20" pans
<input type="checkbox"/> RSCB	8" stainless steel cutting board
<input type="checkbox"/> RSCPGC	Cafeteria single tubular vertical glass guard
<input type="checkbox"/> RSES	End shelf - drop type
<input type="checkbox"/> RSFTS	Solid flat tray slide, 16-gauge stainless steel
<input type="checkbox"/> RSRTS	Solid 3-ribbed tray slide, 16-gauge stainless steel

SPEC B-14

PIPER

The Food-Focused Equipment Company

300 S. 84th Avenue | Wausau, WI 54401
Phone: 800-544-3057 | Fax: 715-842-3125
www.piperonline.net

LIMITED WARRANTY: PIPER PRODUCTS warrants to the original purchaser parts and labor for a period of twelve (12) months from the date of purchase. See manufacturer's complete warranty for details.

It is our policy to build equipment which is design certified by companies that have been accredited at the Federal Level by the Occupational Safety and Health Agency (OSHA) and ANSI as a National Recognized Testing Laboratory. These companies include CSA International, Underwriters Laboratories, and the National Sanitation Foundation. However, a continuing program of product improvement makes it necessary to submit new models to the agencies as they are developed. Consequently, all models may not bear the appropriate labels at all times. We reserve the right to change specifications and product design without notice. Such revisions do not entitle buyer to corresponding changes, improvements, additions or replacements for previously purchased equipment. Information is not for design purposes.